

## ACOUSTI-TOP™ INSTALLATION

### SUBFLOOR AND SITE PREPARATION

1. Concrete substrate should be installed a minimum of 28 days prior to Acousti-Top installation or utilize a Maxxon Vapor Barrier. The substrate surface should be a broom cleaned, contaminant free and should have a smooth finish free from voids and sharp protrusions.
2. The concrete subfloor shall be tested on grade, below grade or elevated slabs for MVER (Moisture Vapor Emission Rate) as per ASTM F1869 (Standard Test Method for Measuring Moisture Vapor Emission Rate of Concrete Subfloor Using Anhydrous Calcium Chloride) or RH (Relative Humidity) as per ASTM 2179 (Standard Test Method for Determining Relative Humidity in Concrete Floor Slabs Using in situ Probes). If excessive moisture is present, corrective actions must be taken.
3. If Acousti-Top is installed over a Maxxon Underlayment, the underlayment must be dry and sealed prior to adhesive application using Maxxon Acrylic (see Maxxon Acrylic TDS for installation instructions).

### ACOUSTI-TOP INSTALLATION—LOOSE LAY METHOD



1. Loose lay Acousti-Top onto clean and contaminant free subfloor with seams butt jointed\*.
2. Tape seams of Acousti-Top with Acousti-Mat<sup>®</sup> Tape.
3. Install finished floor goods per manufacturer's instructions. After the finished flooring is installed, trim the isolation strips to approximately 1/4" below the finished flooring. Fill the groove with a bead of acoustical or elastomeric caulk.

\*The installation of Acousti-Top does not eliminate the need for expansion or movement joints, including perimeter joints. An expansion of 1/4" must be maintained at all times. Use Acousti-Top Isolation Strips to assist in maintaining the expansion gap.

Represented by:

## ACOUSTI-TOP INSTALLATION—DOUBLE GLUE DOWN METHOD

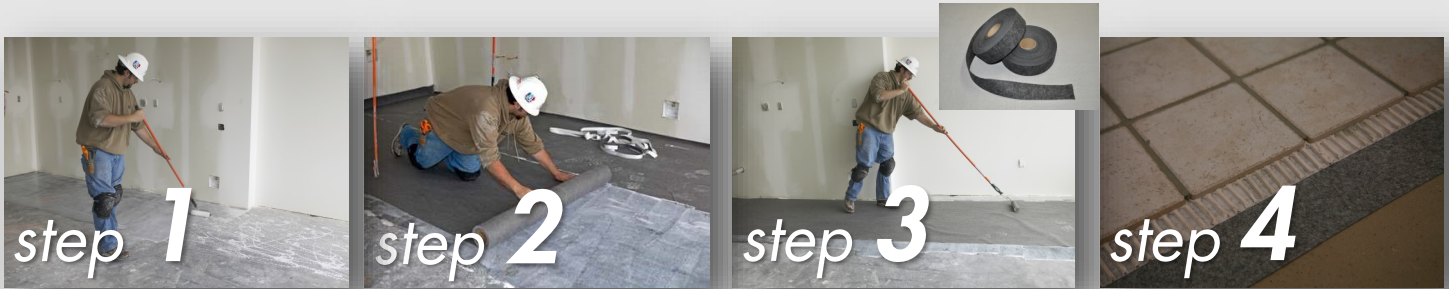

1. Acousti-Top Adhesive is rolled out over clean and contaminant free subfloor. Acousti-Top Adhesive is ready for use directly from the pail—do not dilute. Using a 1/4" nap roller, brush or spray Acousti-Top Adhesive at a rate of 300 ft<sup>2</sup>/gallon. Apply the adhesive in 48" wide strips (slightly wider than the Acousti-Top mat).
2. Place the Acousti-Top mat into the wet adhesive with seams butt jointed\*. During application, take care to avoid wrinkles and bubbles in the mat.
3. Once the adhesive sets, back roll the Acousti-Top to ensure 100% adhesive coverage beneath the mat. This will minimize working over the adhesive throughout the installation. Roll perpendicular to the direction the floor goods will be placed. Install Acousti-Top Isolation strips around the perimeter of the entire room, including door frames, to eliminate flanking paths. Isolation strips are also installed, then taped around any vertical penetration through the floor such as floor drains, tubs, showers, electrical conduits, etc. Tape the seam/joint that is created when the Acousti-Top butts the perimeter isolation barrier strips.
4. The Acousti-Top is ready to receive finished flooring. Finished floor goods, flooring adhesive or tile or mortar bed can be installed directly over the Acousti-Top. Take care to avoid placing flooring seams directly in line with the Acousti-Top seams.

\*The installation of Acousti-Top does not eliminate the need for expansion or movement joints, including perimeter joints. An expansion of 1/4" must be maintained at all times. The use of Acousti-Top Perimeter Isolation Strips will assist in maintaining the expansion gap.

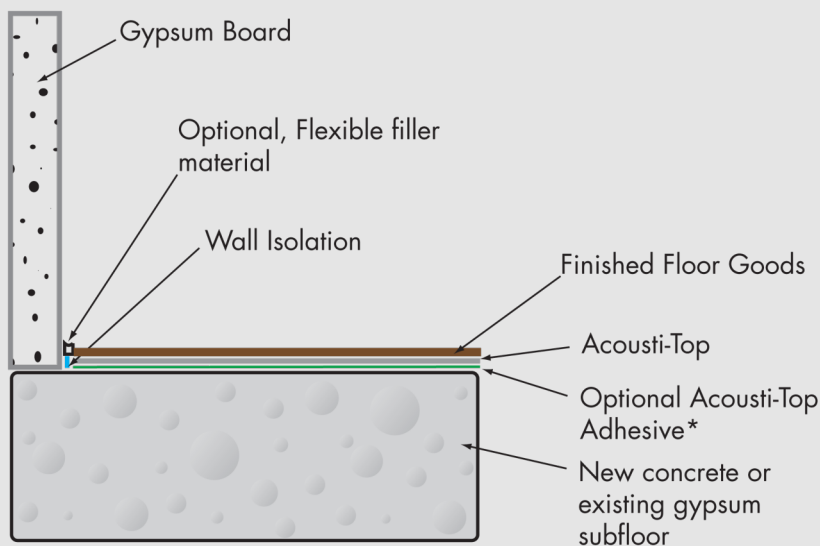

\*Acousti-Top Adhesive used for double-glued applications. NOT required for floating floor applications. For floating applications, Acousti-Top seams should first be butt-jointed and then taped.